

REV.	DESCRIPTION	DATE
A	RELEASE	Nov 30, 2014

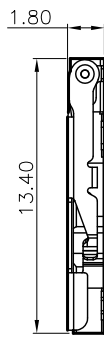

SLIDE SHELL OPEN

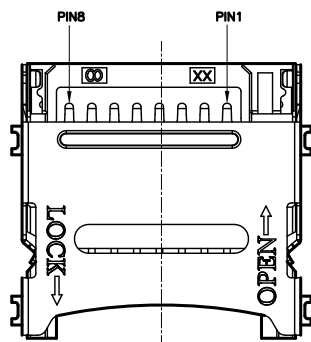
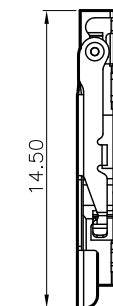

SLIDE SHELL LOCK

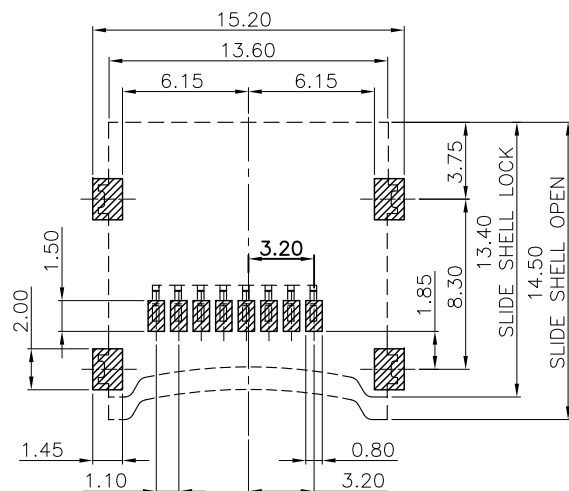
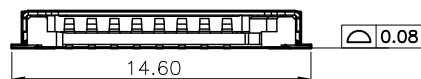
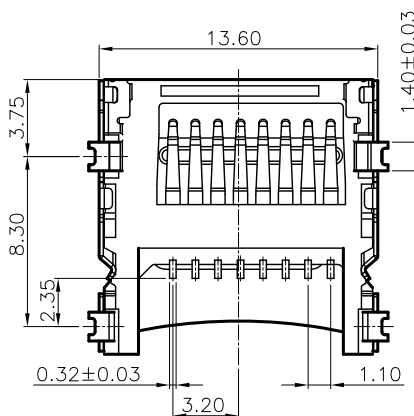

RECOMMEND PCB LAYOUT  
TOLERANCE: ±0.05  
TOP VIEW

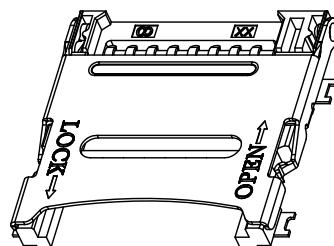

**MATERIALS**

- HOUSING : THERMOPLASTIC ,UL94 V-0.
- TERMINAL : COPPER ALLOY, PLATING SEE TABLE.  
PLATING: GOLD PLATED ON CONTACT AREA,  
G/F GOLD PLATED ON SOLDER TAILS.
- SHELL : SUS.
- SOLDER : COPPER ALLOY .  
PLATING :80u"~120u" TIN PLATED ON SOLDER TAILS,  
50U"~80U" NICKEL PLATED OVERALL.

**SPECIFICATION**

- CURRENT RATING : 0.5 A. MAX.
- VOLTAGE RATING:5V.
- DIELECTRIC WITHSTANDING VOLTAGE :  
500V AC R.M.S. FOR 1 MINUTE.
- INSULATION RESISTANCE : 100MΩ MIN.AT 5V DC.
- CONTACT RESISTANCE : 50mΩ MAX.
- OPERATING TEMPERATURE : -30°C TO +85°C.
- DURABILITY:5000 CYCLES.

**PART NUMBER INFORMATION :**

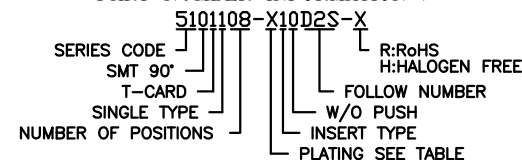

DESCRIPTION OF PLATING ON TERMINALS			
NO.	EXPLAIN	NO.	EXPLAIN
0	GOLD FLASH	3	GOLD 15u"
1	GOLD 5u"	4	GOLD 20u"
2	GOLD 10u"	H	G/F + TIN

PIN1	DAT2
PIN2	CD/DAT3
PIN3	CMD
PIN4	VDD
PIN5	CLK
PIN6	VSS
PIN7	DAT0
PIN8	DAT1
PIN NO.	

TOLERANCE	
.0=±0.25	
.00=±0.15	
.000=±0.05	
ANG.=±3°	
UNITS : mm	
SCALE NONE	SIZE A7
SHEET 1 OF 1	REV. A

DRAWER		<b>INMO</b> 东莞市英墨电子有限公司 INMO Electronics Co.,Ltd
CHECK		
APP'D		NAME
PRODUCT SPEC.		T-FLASH SOCKET 掀盖式/无柱(1.8U)
		DRAW NO.
		R5101108-X10D2S-X